

10% DISCOUNT

10% Discount in The Shop at King's
on presentation of this leaflet.

Not to be used in conjunction with any other offer or discount.

King's College receives generous support from the King's College Chapel Foundation, which helps to maintain the Chapel building and services.

If you would like to help, please contact the King's College Chapel Foundation,

Telephone 01223 331313, fax 01223 331347.

Email chapel.foundation@kings.cam.ac.uk

Lavatories

There are no public lavatories in the College. The nearest are at Grand Arcade.

Photography

You may take photographs of the College grounds, but we ask you not to use flash photography inside the Chapel. Views of the interior may be bought from the "Shop at Kings".

The College and its Grounds

During the Easter Term (mid-April to mid-June), which is the examination period in Cambridge, the College grounds are closed to visitors, but the Chapel remains open.

Leave the Chapel by the **South Porch** **13** (March to September). You are now in the Front Court. On your right is the **Gibbs Building** **A**, begun in 1724 and completed in 1729, and named after its architect. The building's restrained classical façade of Portland stone provides a brilliant foil to the flamboyant late Gothic of the Chapel. Its rooms are mostly used for teaching, study and administration.

To continue the tour you should turn left and walk round the front court. Opposite the Gibbs Building you can see the delicate tracery of the **Gatehouse and the Screen** **B**, designed in the neo-Gothic fashion of the 1820s by William Wilkins (who also designed the National Gallery in London). The construction of the Gatehouse and the Screen involved the controversial demolition of half of the buildings in King's Parade, but they are now a much-admired landmark at the heart of the town.

You will now pass by the **Dining Hall** **C**, part of the south range of the Front Court, all of which was designed by Wilkins. The Dining Hall is used by the College Community, as well as providing a splendid setting for formal dinners. It remains an important focus for the College community.

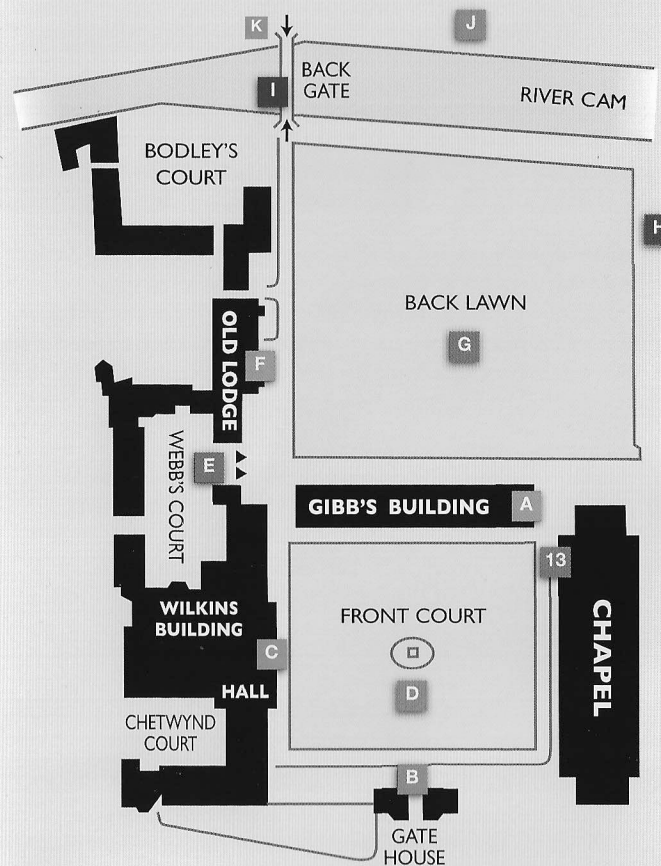

Look across the **Front Lawn** at the **Fountain** **D** surmounted by the Statue of Henry VI, the 'boy king', above the symbolic figures of Religion and Learning.

Now pass by the **Library** **E**, and the **Old Provost's Lodge** **F** (both designed by Wilkins), and look across the **Great Lawn** **G**, which extends down towards the river on one side, and towards **Clare College** **H** on another. **The Bridge** **I** affords picturesque views of the River Cam, passing through Clare College to the north, and Queens' College to the south. On the west side of the Bridge lies **Scholars' Piece** **J** a glimpse of countryside in the heart of Cambridge.

If you wish, you may leave the College by proceeding along the curved path, designed in the spirit of early nineteenth century romanticism by the evangelical churchman, Charles Simeon, through to the **Back Gate** **K**.